



39 GHz Repeater with Holographic Beam Forming® Technology

Gbps+ Real Throughput Through Glass, Up to 1 km Range

Ultra-Low Latency

Direct Power or Powered Through Glass

version 2022.1

PIVOTAL
COMMWARE®

Overview

Pivotal Commware introduces the world's first and only on-glass beamforming repeater, Echo 5G™, designed to counteract signal loss at millimeter wave frequencies. The Echo 5G enables outdoor-to-indoor signal transitions so users can ubiquitously enjoy the immersive 5G experiences that only mmWave capacity can deliver.

Breakthrough in Electromagnetic Physics

The Echo 5G uses Pivotal's patented Holographic Beam Forming® (HBF) to counteract window penetration and reflection loss so consumers and enterprises can enjoy Gigabit speeds beyond the reach of cable and DSL. HBF offers the lowest available size, weight and power consumption beamformer profile and is an essential element in the 5G Ecosystem.

Transforming Business from the Inside

Only mmWave 5G provides the Gigabit-per-second and ultra-low latency connectivity to deliver virtual/augmented reality and immersive experiences to enterprises. Pivotal brings this capability inside using its uniquely lightweight and low-power Echo 5G that attaches directly to glass and powers through it from the inside. The Echo 5G installs in minutes and closes the business case for carriers offering end-to-end solutions that will transform the way people work.



Key Features

The Echo 5G offers the following features:

- On-the-window RF repeater
- Overcomes standard glass penetration loss by boosting the signal up to 30 dB
- Overcomes reflection loss by scanning to near horizon in azimuth
- Narrow and steerable beam towards gNB, wide static beam towards indoor CPE/UE
- Outdoor Unit (ODU) with HBF antenna and RF Front End functions, wirelessly powered through the window (Nominal: 20 Watts)
- Indoor Unit (IDU) with wireless power module and AC adapter interface
- Self-commissioning with auto acquisition and auto ranging functions
- Enables Gbps service indoors at distances up to 1 kilometer from the base station and 100+ ft into the interior of the building
- Compatible with 5G NR non-standalone (NSA) EN-DC and standalone (SA)
- Small form factor, 7" dia. x 1.5 depth", less than 3 lbs.
- Cloud based remote OA&M and optimization functions via IoT
- 5 nanosecond latency



Immersive Meetings

Extending the Reach of 5G mmWave Into the Enterprise

The Echo 5G delivers on the promise of 5G and edge computing to enterprise customers by opening a portal between indoors and outdoors for low-latency, high throughput mmWave signals.

mmWave Signals

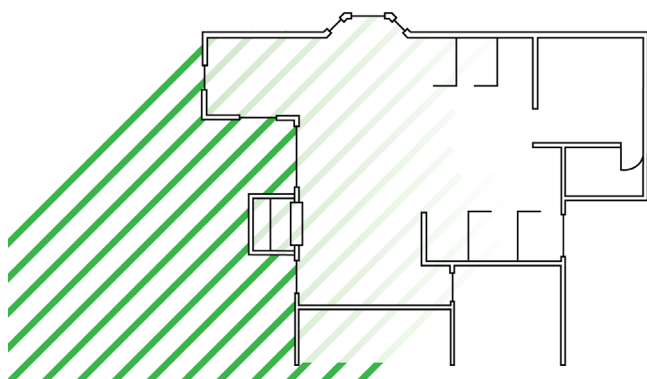

Without Echo 5G

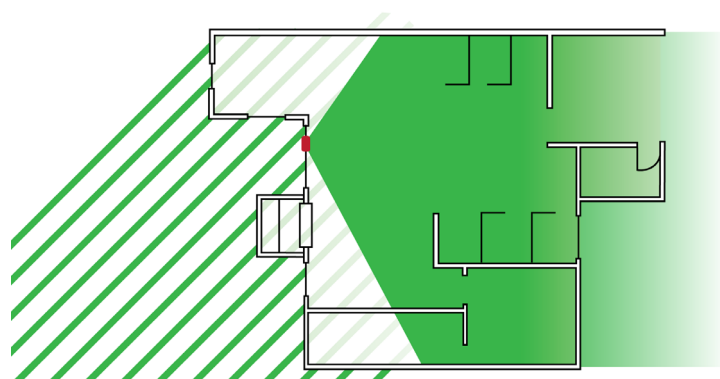

With Echo 5G

Echo 5G Installation

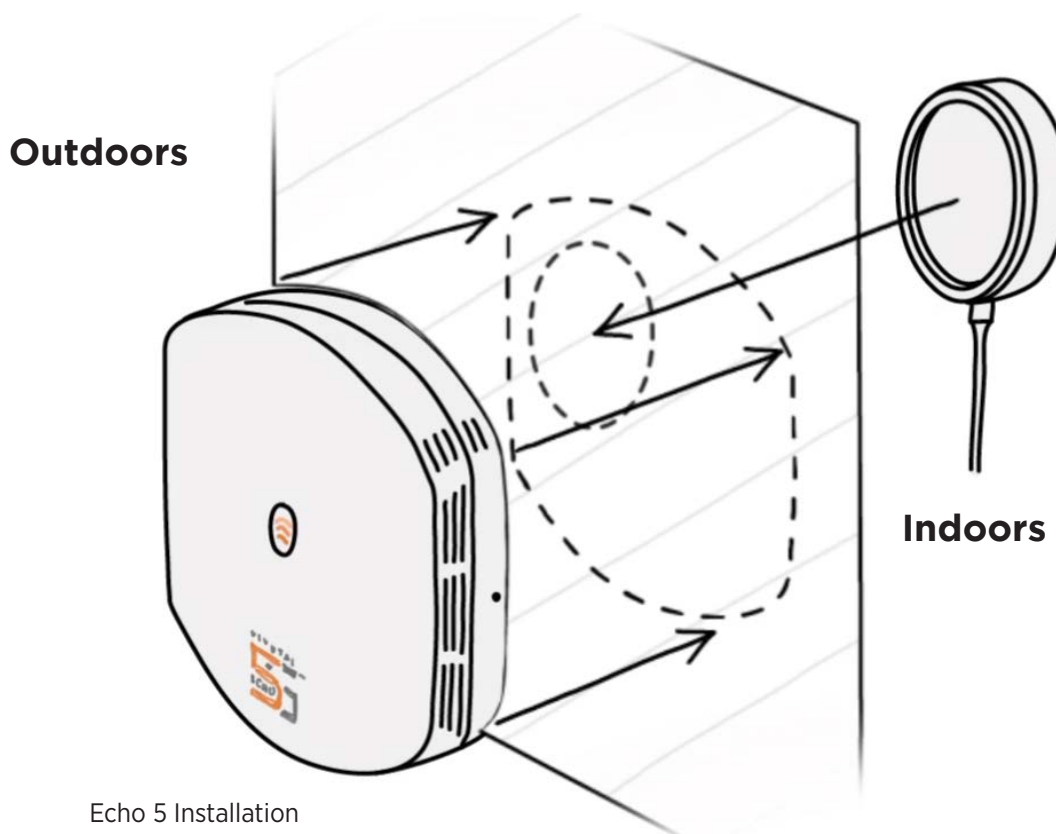

Echo 5 Installation

5G mmWave Experiences Using Echo

Augmented, virtual, mixed and extended reality technologies require extremely high bandwidth and extremely low latency. The combination of mmWave 5G and Echo 5G will allow businesses to increase productivity and innovation while pursuing new revenue opportunities.



Immersive Learning



eSports and Gaming

Parameter	Specification
Frequency of operation	37.6GHz – 40GHz
HBF az scan envelope	+/-76°
HBF el scan envelope	+/-30°
HBF antenna gain (donor side)	16 dB
HPBW towards gNB - azimuth	5°
HPBW towards gNB - elevation	20°
HBF scan loss	6 dB at 76°
Static antenna gain (service side)	6 dB
HPBW towards CPE/UE - azimuth	120°
HPBW towards CPE/UE - elevation	60°
Gain tunable range - DL	20 dB
Gain tunable range - UL	20 dB
Max electronic gain - DL	55 dB
Max electronic gain - UL	62 dB
Max EIRP - DL	30 dBm
Max EIRP - UL	30 dBm
Min noise figure - DL	5 dB
Min noise figure - UL	5 dB
In-band ripple (per 100 MHz channel)	2 dB
Operating Temperature	-30 to 45° C
Dimensions	7" circle, 1.5" depth RF ODU, and 3.7" circle, 1.1" depth IDU
Weight RF ODU	2.4 lbs.
Weight IDU	0.4 lbs.
IP Rating	IP54 for ODU; IP32 for IDU
Support Glass Type	Standard: single and double pane
Mounting	Adhesive, VHB
Max. Power Consumption	Nominal: 20 Watts, Max: 36 Watts (from outlet)
Power Method	Direct power to ODU or AC adapter for IDU and wireless power magnetically induced to ODU
Configuration Management Interface	Bluetooth® and CAT 1
Commissioning	Automated
Donor Range (to gNB)	Up to 3000 ft
Indoor Range (to CPE/UE)	100+ ft

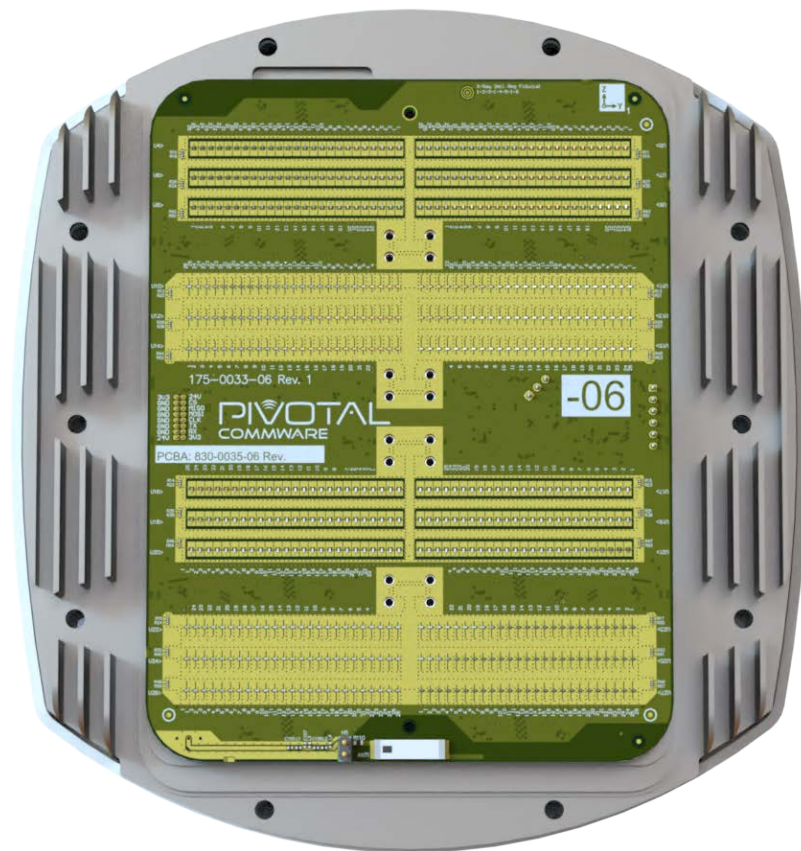

Specifications are subject to change. All rights reserved. Pivotal, Pivotal Commware, Pivotal Echo 5G and Holographic Beam Forming, and their logos, are trademarks or registered trademarks of Pivotal Commware, Inc.

version 2022.1

PIVOTAL
COMMWARE®
www.pivotalcommware.com